

## CASEMENT

SYSTEM

### Sightlines

Frame 70 mm, Sash 70 mm

### Polyamide Strip Length

32 mm

### Profile Thickness

Window 1.6 mm

### Glazing

Max. 44 mm, Min. 23 mm

### Maximum Sash Dimensions

#### Slim Sash (Side Hung):

Width (L) 950 mm, Height (H) 1300 mm

#### Slim Sash (Top Hung):

Width (L) 1200 mm, Height (H) 1300 mm

#### Heavy Duty Sash (Side Hung):

Width (L) 750 mm, Height (H) 1750 mm

#### Heavy Duty Sash (Top Hung):

Width (L) 1800 mm, Height (H) 1800 mm

### Maximum Sash Weight

Side Hung Slim Sash: 35 kg

Top Hung Slim Sash: 50 kg

Side Hung Heavy Duty Sash: 42 kg

Top Hung Heavy Duty Sash: 100 kg

Consult maximum weight and dimensions according to typologies



CASEMENT SYSTEM





Thermally broken window that allows for both side hung and top hung outward openings. This solution, with a thermal break zone of 32 mm and a transmittance  $U_w$  from 1.0  $W/m^2K$ , has the British security certification PAS 24, being especially suitable for this market.



- High thermal & acoustic performance
- Slim sightlines
- Flush option available
- High security



**BFRC Rating**  
kWh/(m<sup>2</sup>·yr)

>20	A ++
>10 to 20	A +
0 to <-10	A ✓
-10 to <0	B
-20 to <-10	C
-30 to <-20	D
-50 to <-30	E

Double glazing

**BFRC Rating**  
kWh/(m<sup>2</sup>·yr)

>20	A ++ ✓
>10 to 20	A +
0 to <-10	A ✓
-10 to <0	B
-20 to <-10	C
-30 to <-20	D
-50 to <-30	E

Triple glazing



**FEATURES**

U value		Double glazing * $U_w$ from 1.4 ( $W/m^2K$ )	Triple glazing * $U_w \geq 1.0$ ( $W/m^2K$ )
Acoustic insulation		Rw up to 45 dB	
Air permeability		Class 4	
Water tightness		Class E1200	
Wind resistance		Class CE 2400	
Security test	PAS24 ✓	Passed	

\* Double glazing  $U_g=1.0$  / Triple glazing  $U_g=0.5$   
Security test: Reference test 1.438 x 1.33 m / 1 sash



**FLUSH VERSION**

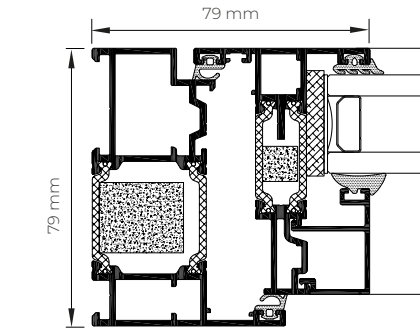

**STANDARD VERSION**

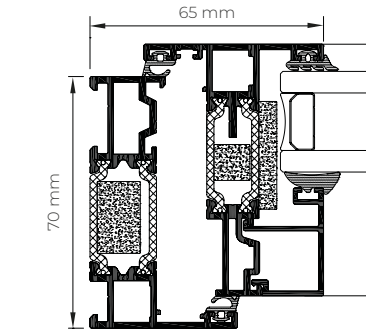

**DRAINAGE SUBCILLS**

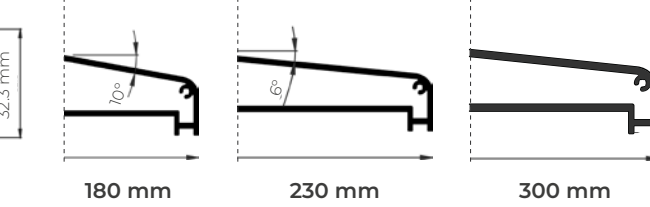
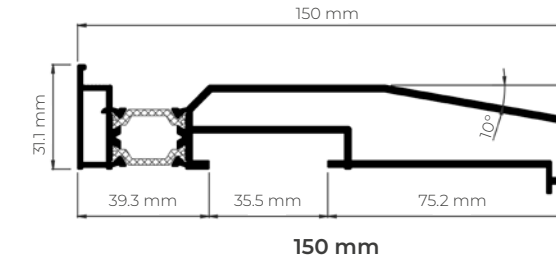
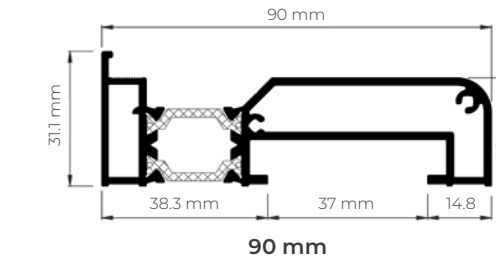

**HEAD EXTENSION**

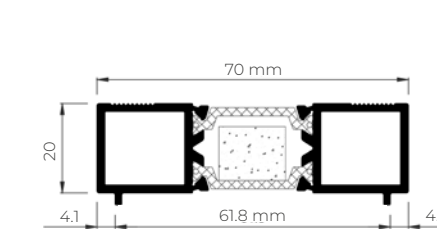

Head Extension 20 mm

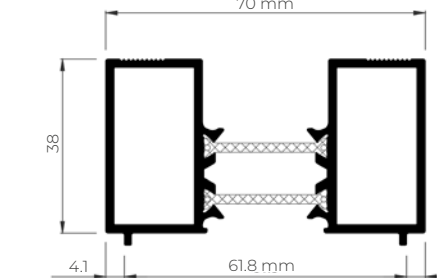

Head Extension 38 mm

**OPENING POSSIBILITIES**



**POSSIBILITIES**

